

LIMITING WALL HEIGHTS - NON STRUCTURAL

NON STRUCTURAL LIMITING WALL HEIGHTS												
Web Depth	Part Number	Gauge	Spacing (in) OC	5 psf			10 psf			15 psf		
				L/120	L/240	L/360	L/120	L/240	L/360	L/120	L/240	L/360
1 5/8"	162S125-18	25	12	9' 3"	7' 7"	6' 8"	6' 6"	6' 0"	5' 3"	5' 4"	5' 3"	4' 7"
			16	8' 0"	6' 11"	6' 0"	5' 8"	5' 6"	4' 9"	4' 7"	4' 7"	4' 2"
			24	6' 6"	6' 0"	5' 3"	4' 7"	4' 7"	4' 2"	3' 9"	3' 9"	3' 8"
	162S125-27	22	12	11' 3"	8' 11"	7' 9"	8' 4"	7' 1"	6' 2"	6' 10"	6' 2"	5' 5"
			16	10' 3"	8' 1"	7' 1"	7' 3"	6' 5"	5' 7"	5' 11"	5' 7"	4' 11"
			24	8' 4"	7' 1"	6' 2"	5' 11"	5' 7"	4' 11"	4' 10"	4' 10"	4' 3"
	162S125-30	20 DW	12	11' 7"	9' 2"	8' 0"	8' 11"	7' 3"	6' 4"	7' 4"	6' 4"	5' 7"
			16	10' 6"	8' 4"	7' 3"	7' 9"	6' 7"	5' 9"	6' 4"	5' 9"	5' 0"
			24	8' 11"	7' 3"	6' 4"	6' 4"	5' 9"	5' 0"	5' 2"	5' 0"	4' 5"
	162S125-33	20 ST	12	12' 0"	9' 6"	8' 3"	9' 6"	7' 6"	6' 7"	7' 10"	6' 7"	5' 9"
			16	10' 10"	8' 7"	7' 6"	8' 4"	6' 10"	6' 0"	6' 10"	6' 0"	5' 2"
			24	9' 6"	7' 6"	6' 7"	6' 10"	6' 0"	5' 2"	5' 7"	5' 2"	4' 7"
2 1/2"	250S125-18	25	12	12' 9"	10' 6"	9' 2"	9' 0"	8' 4"	7' 3"	7' 4"	7' 3"	6' 4"
			16	11' 1"	9' 6"	8' 4"	7' 10"	7' 7"	6' 4"	6' 4"	6' 4"	5' 9"
			24	9' 0"	8' 4"	7' 3"	6' 4"	6' 4"	5' 9"	5' 2"	5' 2"	5' 0"
	250S125-27	22	12	15' 7"	12' 4"	10' 9"	11' 4"	9' 9"	8' 6"	9' 3"	8' 6"	7' 5"
			16	13' 10"	11' 2"	9' 9"	9' 9"	8' 11"	7' 9"	8' 0"	7' 9"	6' 9"
			24	11' 4"	9' 9"	8' 6"	8' 0"	7' 9"	6' 9"	6' 6"	6' 6"	5' 11"
	250S125-30	20 DW	12	16' 1"	12' 9"	11' 1"	12' 1"	10' 1"	8' 10"	9' 10"	8' 10"	7' 8"
			16	14' 7"	11' 7"	10' 1"	10' 5"	9' 2"	8' 0"	8' 6"	8' 0"	7' 0"
			24	12' 1"	10' 1"	8' 10"	8' 6"	8' 0"	7' 0"	6' 11"	6' 11"	6' 1"
	250S125-33	20 ST	12	16' 7"	13' 2"	11' 6"	12' 11"	10' 5"	9' 1"	10' 7"	9' 1"	7' 11"
			16	15' 1"	11' 11"	10' 5"	11' 3"	9' 6"	8' 3"	9' 2"	8' 3"	7' 3"
			24	12' 11"	10' 5"	9' 1"	9' 2"	8' 3"	7' 3"	7' 6"	7' 3"	6' 4"
250S125-43	18	12	18' 0"	14' 4"	12' 6"	14' 4"	11' 4"	11' 4"	9' 11"	12' 5"	8' 8"	
		16	16' 5"	13' 0"	11' 4"	13' 0"	10' 4"	9' 0"	10' 9"	9' 0"	7' 10"	
		24	14' 4"	11' 4"	9' 11"	10' 9"	9' 0"	7' 10"	8' 9"	7' 10"	6' 10"	
3 1/2"	350S125-18	25	12	14' 2"	13' 10"	12' 1"	10' 0"	10' 0"	9' 7"	8' 2"	8' 2"	8' 2"
			16	12' 3"	12' 3"	10' 11"	8' 8"	8' 8"	7' 1"	7' 1"	7' 1"	7' 1"
			24	10' 0"	10' 0"	9' 7"	7' 1"	7' 1"	7' 1"	5' 9"	5' 9"	5' 9"
	350S125-27	22	12	18' 6"	16' 0"	14' 0"	13' 1"	12' 8"	11' 1"	10' 8"	10' 8"	9' 8"
			16	16' 0"	14' 6"	12' 8"	11' 4"	11' 4"	10' 1"	9' 3"	9' 3"	8' 9"
			24	13' 1"	12' 8"	11' 1"	9' 3"	9' 3"	8' 9"	7' 6"	7' 6"	7' 6"
	350S125-30	20 DW	12	20' 0"	16' 6"	14' 5"	14' 2"	13' 1"	11' 5"	11' 6"	11' 6"	10' 0"
			16	17' 4"	15' 0"	13' 1"	12' 3"	11' 11"	10' 5"	10' 0"	10' 0"	9' 1"
			24	14' 2"	13' 1"	11' 5"	10' 0"	10' 0"	9' 1"	8' 2"	8' 2"	7' 11"
	350S125-33	20 ST	12	21' 6"	17' 1"	14' 11"	15' 4"	13' 6"	11' 10"	12' 6"	11' 10"	10' 4"
			16	18' 9"	15' 6"	13' 6"	13' 3"	12' 4"	10' 9"	10' 10"	10' 9"	9' 5"
			24	15' 4"	13' 6"	11' 10"	10' 10"	10' 9"	9' 5"	8' 10"	8' 10"	8' 2"
350S125-43	18	12	23' 5"	18' 7"	16' 3"	18' 5"	14' 9"	12' 11"	15' 0"	12' 11"	11' 3"	
		16	21' 4"	16' 11"	14' 9"	15' 11"	13' 5"	11' 8"	13' 0"	10' 8"	10' 3"	
		24	18' 5"	14' 9"	12' 11"	13' 0"	11' 8"	10' 3"	10' 7"	10' 3"	8' 11"	
350S125-54	16	12	25' 2"	19' 11"	17' 5"	19' 11"	15' 10"	13' 10"	16' 11"	13' 10"	12' 1"	
		16	22' 10"	18' 1"	15' 10"	18' 0"	14' 4"	12' 7"	14' 8"	12' 7"	10' 11"	
		24	19' 11"	15' 10"	13' 10"	14' 8"	12' 7"	10' 11"	12' 0"	10' 11"	9' 7"	
350S125-68	14	12	26' 10"	21' 3"	18' 7"	21' 3"	16' 10"	14' 9"	18' 7"	14' 9"	12' 10"	
		16	24' 4"	19' 4"	16' 10"	19' 4"	15' 4"	13' 5"	16' 4"	13' 5"	11' 8"	
		24	21' 3"	16' 10"	14' 9"	16' 4"	13' 5"	11' 8"	13' 4"	11' 8"	10' 2"	
3 5/8"	362S125-18	25	12	14' 5"	14' 2"	12' 5"	10' 2"	10' 2"	9' 10"	8' 4"	8' 4"	8' 4"
			16	12' 6"	12' 6"	11' 3"	8' 10"	8' 10"	8' 10"	7' 2"	7' 2"	7' 2"
			24	10' 2"	10' 2"	9' 10"	7' 2"	7' 2"	7' 2"	5' 10"	5' 10"	5' 10"
	362S125-27	22	12	18' 11"	16' 5"	14' 4"	13' 4"	13' 1"	11' 5"	10' 11"	10' 11"	9' 11"
			16	16' 4"	14' 11"	13' 1"	11' 7"	11' 7"	10' 4"	9' 5"	9' 5"	9' 0"
			24	13' 4"	13' 1"	11' 5"	9' 5"	9' 5"	9' 0"	7' 8"	7' 8"	7' 8"
	362S125-30	20 DW	12	20' 5"	17' 0"	14' 10"	14' 5"	13' 6"	11' 9"	11' 9"	11' 9"	10' 3"
			16	17' 8"	15' 5"	13' 6"	12' 6"	12' 3"	10' 8"	10' 2"	10' 2"	9' 4"
			24	14' 5"	13' 6"	11' 9"	10' 2"	10' 2"	9' 4"	8' 4"	8' 4"	8' 2"
	362S125-33	20 ST	12	22' 1"	17' 7"	15' 4"	15' 8"	13' 11"	12' 2"	12' 9"	12' 2"	10' 7"
			16	19' 2"	15' 11"	13' 11"	13' 6"	12' 8"	11' 0"	11' 0"	11' 0"	9' 8"
			24	15' 8"	13' 11"	12' 2"	11' 0"	11' 0"	9' 8"	9' 0"	9' 0"	8' 5"
362S125-43	18	12	24' 1"	19' 2"	16' 8"	18' 10"	15' 2"	13' 3"	15' 4"	13' 3"	11' 7"	
		16	21' 11"	17' 5"	15' 2"	16' 3"	13' 9"	12' 0"	13' 3"	12' 0"	10' 6"	
		24	18' 10"	15' 2"	13' 3"	13' 3"	12' 0"	10' 6"	10' 10"	10' 6"	9' 2"	
362S125-54	16	12	25' 10"	20' 6"	17' 11"	20' 6"	16' 3"	14' 2"	17' 4"	14' 2"	12' 5"	
		16	23' 6"	18' 7"	16' 3"	18' 4"	14' 9"	12' 11"	15' 0"	12' 11"	11' 3"	
		24	20' 6"	16' 3"	14' 2"	15' 0"	12' 11"	11' 3"	12' 3"	11' 3"	9' 10"	
362S125-68	14	12	27' 7"	21' 10"	19' 1"	21' 10"	17' 4"	15' 2"	19' 1"	15' 2"	13' 3"	
		16	25' 0"	19' 10"	17' 4"	19' 10"	15' 9"	13' 9"	16' 10"	13' 9"	12' 0"	
		24	21' 10"	17' 4"	15' 2"	16' 10"	13' 9"	12' 0"	13' 8"	12' 0"	10' 6"	

NON-STRUCTURAL WALL HEIGHTS NOTES

- Listed lateral pressures have not been modified for strength or deflection checks.
- Studs are assumed to be adequately braced to develop full allowable moment, Ma.
- End reactions must be checked for web crippling.
- Fy = 33 ksi for 18-mil through 43-mil studs; Fy = 50 ksi for 54-mil and thicker sections.
- Allowable Heights based on steel properties only (non-composite design).
- End shear considered to be at an unpunched section.

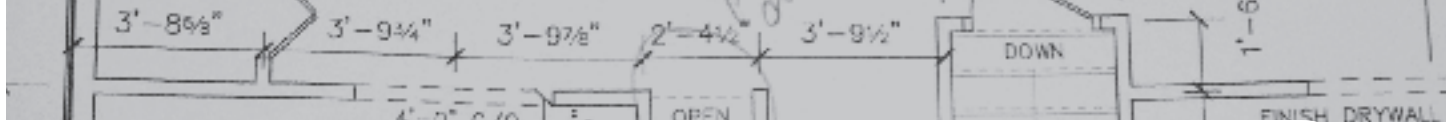

LIMITING WALL HEIGHTS - NON STRUCTURAL

NON STRUCTURAL LIMITING WALL HEIGHTS													
Web Depth	Part Number	Gauge	Spacing (in) OC	5 psf			10 psf			15 psf			
				L/120	L/240	L/360	L/120	L/240	L/360	L/120	L/240	L/360	
4"	400S125-18	25	12	15' 2"	15' 2"	13' 5"	10' 9"	10' 9"	10' 8"	8' 9"	8' 9"	8' 9"	
			16	13' 2"	13' 2"	12' 2"	9' 3"	9' 3"	9' 3"	7' 7"	7' 7"	7' 7"	
			24	10' 9"	10' 9"	10' 8"	7' 7"	7' 7"	7' 7"	6' 2"	6' 2"	6' 2"	
	400S125-27	22	12	19' 11"	17' 9"	15' 6"	14' 1"	14' 1"	12' 4"	11' 6"	11' 6"	10' 9"	
			16	17' 3"	16' 2"	14' 1"	12' 2"	12' 2"	11' 2"	9' 11"	9' 11"	9' 9"	
			24	14' 1"	14' 1"	12' 4"	9' 11"	9' 11"	9' 9"	8' 1"	8' 1"	8' 1"	
	400S125-30	20 DW	12	21' 6"	18' 4"	16' 0"	15' 3"	14' 7"	12' 8"	12' 5"	12' 5"	11' 1"	
			16	18' 8"	16' 8"	14' 7"	13' 2"	13' 2"	11' 6"	10' 9"	10' 9"	10' 1"	
			24	15' 3"	14' 7"	12' 8"	10' 9"	10' 9"	10' 1"	8' 9"	8' 9"	8' 9"	
	400S125-33	20 ST	12	23' 4"	19' 0"	16' 7"	16' 6"	15' 1"	13' 2"	13' 2"	13' 2"	11' 6"	
			16	20' 3"	17' 3"	15' 1"	14' 4"	13' 8"	11' 11"	11' 8"	11' 8"	10' 5"	
			24	16' 6"	15' 1"	13' 2"	11' 8"	11' 8"	10' 5"	9' 6"	9' 6"	9' 1"	
	400S125-43	18	12	26' 1"	20' 8"	18' 1"	19' 11"	16' 5"	14' 4"	16' 3"	14' 4"	12' 6"	
			16	23' 8"	18' 10"	16' 5"	17' 3"	14' 11"	13' 0"	14' 1"	13' 0"	11' 4"	
			24	19' 11"	16' 5"	14' 4"	14' 1"	13' 0"	11' 4"	11' 6"	11' 4"	9' 11"	
	400S125-54	16	12	27' 11"	22' 2"	19' 4"	22' 2"	17' 7"	15' 4"	18' 5"	15' 4"	13' 5"	
			16	25' 5"	20' 2"	17' 7"	19' 6"	16' 0"	13' 11"	15' 11"	13' 11"	12' 2"	
			24	22' 2"	17' 7"	15' 4"	15' 11"	13' 11"	12' 2"	13' 0"	12' 2"	10' 8"	
	400S125-68	14	12	29' 10"	23' 8"	20' 8"	23' 8"	18' 9"	16' 5"	20' 8"	16' 5"	14' 4"	
			16	27' 1"	21' 6"	18' 9"	21' 6"	17' 1"	14' 11"	17' 11"	14' 11"	13' 0"	
			24	23' 8"	18' 9"	16' 5"	17' 11"	14' 11"	13' 0"	14' 8"	13' 0"	11' 4"	
	5 1/2"	550S125-27	22	12	25' 6"	22' 8"	19' 10"	18' 0"	18' 0"	15' 9"	14' 8"	14' 8"	13' 9"
				16	22' 1"	20' 8"	18' 0"	15' 7"	15' 7"	14' 3"	12' 9"	12' 9"	12' 6"
				24	18' 0"	18' 0"	15' 9"	12' 9"	12' 9"	12' 6"	10' 5"	10' 5"	10' 5"
550S125-30		20 DW	12	27' 7"	23' 6"	20' 6"	19' 6"	18' 8"	16' 3"	15' 11"	15' 11"	14' 3"	
			16	23' 11"	21' 4"	18' 8"	16' 10"	16' 10"	14' 9"	13' 9"	13' 9"	12' 11"	
			24	19' 6"	18' 8"	16' 3"	13' 9"	13' 9"	12' 11"	11' 3"	11' 3"	11' 3"	
550S125-33		20 ST	12	30' 0"	24' 4"	21' 3"	21' 2"	19' 4"	16' 11"	17' 3"	16' 11"	14' 9"	
			16	25' 11"	22' 2"	19' 4"	18' 4"	17' 7"	15' 4"	15' 0"	15' 0"	13' 5"	
			24	21' 2"	19' 4"	16' 11"	15' 0"	15' 0"	13' 5"	12' 2"	12' 2"	11' 8"	
550S125-43		18	12	33' 8"	26' 8"	23' 4"	25' 8"	21' 2"	18' 6"	20' 11"	18' 6"	16' 2"	
			16	30' 7"	24' 3"	21' 2"	22' 2"	19' 3"	16' 10"	18' 1"	16' 10"	14' 8"	
			24	25' 8"	21' 2"	18' 6"	18' 1"	16' 10"	14' 8"	14' 9"	14' 8"	12' 10"	
550S125-54		16	12	36' 2"	28' 8"	25' 0"	28' 8"	22' 9"	19' 10"	23' 10"	19' 10"	17' 4"	
			16	32' 10"	26' 1"	22' 9"	25' 3"	20' 8"	18' 1"	20' 7"	18' 1"	15' 9"	
			24	28' 8"	22' 9"	19' 10"	20' 7"	18' 1"	15' 9"	16' 10"	15' 9"	13' 9"	
550S125-68		14	12	38' 8"	30' 8"	26' 9"	30' 8"	24' 4"	21' 3"	26' 9"	21' 3"	18' 7"	
			16	35' 1"	27' 10"	24' 4"	27' 10"	22' 1"	19' 4"	24' 4"	19' 4"	16' 10"	
			24	30' 8"	24' 4"	21' 3"	24' 4"	19' 4"	16' 10"	20' 6"	16' 10"	14' 9"	
6"		600S125-27	22	12	26' 9"	24' 3"	21' 2"	18' 11"	18' 11"	16' 10"	15' 5"	15' 5"	14' 8"
				16	23' 2"	22' 1"	19' 3"	16' 4"	16' 4"	15' 3"	13' 4"	13' 4"	13' 4"
				24	18' 11"	18' 11"	16' 10"	13' 4"	13' 4"	13' 4"	10' 11"	10' 11"	10' 11"
		600S125-30	20 DW	12	28' 11"	25' 2"	21' 11"	20' 5"	19' 11"	17' 5"	16' 8"	16' 8"	15' 2"
				16	25' 1"	22' 10"	19' 11"	17' 8"	17' 8"	15' 10"	14' 5"	14' 5"	13' 10"
				24	20' 5"	19' 11"	17' 5"	14' 5"	14' 5"	13' 10"	11' 9"	11' 9"	11' 9"
	600S125-33	20 ST	12	31' 6"	26' 1"	22' 9"	22' 3"	20' 8"	18' 1"	18' 2"	18' 1"	15' 9"	
			16	27' 3"	23' 8"	20' 8"	19' 3"	18' 10"	16' 5"	15' 9"	15' 9"	14' 4"	
			24	22' 3"	20' 8"	18' 1"	15' 9"	15' 9"	14' 4"	12' 10"	12' 10"	12' 6"	
	600S125-43	18	12	36' 2"	28' 8"	25' 1"	27' 0"	22' 9"	19' 10"	22' 1"	19' 10"	17' 4"	
			16	32' 10"	26' 1"	22' 9"	23' 5"	20' 8"	18' 1"	18' 1"	18' 1"	15' 9"	
			24	27' 0"	22' 9"	19' 10"	19' 1"	18' 1"	15' 9"	15' 7"	15' 7"	13' 9"	
	600S125-54	16	12	38' 10"	30' 9"	26' 11"	30' 9"	24' 5"	21' 4"	25' 3"	21' 4"	18' 8"	
			16	35' 3"	28' 0"	24' 5"	26' 9"	22' 2"	19' 5"	21' 10"	19' 5"	16' 11"	
			24	30' 9"	24' 5"	21' 4"	21' 10"	19' 5"	16' 11"	17' 10"	16' 11"	14' 9"	
	600S125-68	14	12	41' 6"	32' 11"	28' 9"	32' 11"	26' 2"	22' 10"	28' 9"	22' 10"	19' 11"	
			16	37' 8"	29' 11"	26' 2"	29' 11"	23' 9"	20' 9"	26' 2"	20' 9"	18' 1"	
			24	32' 11"	26' 2"	22' 10"	26' 2"	20' 9"	18' 1"	21' 10"	18' 1"	15' 10"	
	8"	800S125-30	20 DW	12	33' 10"	31' 4"	27' 5"	23' 11"	23' 11"	21' 9"	19' 6"	19' 6"	19' 0"
				16	29' 4"	28' 6"	24' 11"	20' 8"	20' 8"	19' 9"	16' 11"	16' 11"	16' 11"
				24	23' 11"	23' 11"	21' 9"	16' 11"	16' 11"	16' 11"	13' 9"	13' 9"	13' 9"
		800S125-33	20 ST	12	36' 10"	32' 7"	28' 6"	26' 1"	25' 10"	22' 7"	21' 3"	21' 3"	19' 9"
				16	31' 11"	29' 7"	25' 10"	22' 7"	22' 7"	20' 6"	18' 5"	18' 5"	17' 11"
				24	26' 1"	25' 10"	22' 7"	18' 5"	18' 5"	17' 11"	15' 0"	15' 0"	15' 0"
800S125-43		18	12	45' 1"	36' 0"	31' 6"	31' 11"	28' 7"	25' 0"	26' 0"	25' 0"	21' 10"	
			16	39' 1"	32' 9"	28' 7"	27' 7"	26' 0"	22' 8"	22' 6"	22' 6"	19' 10"	
			24	31' 11"	28' 7"	25' 0"	22' 6"	22' 6"	19' 10"	18' 5"	18' 5"	17' 4"	
800S125-54		16	12	49' 3"	39' 1"	34' 2"	36' 11"	31' 0"	27' 1"	30' 1"	27' 1"	23' 8"	
			16	44' 9"	35' 6"	31' 0"	31' 11"	28' 2"	24' 7"	26' 1"	24' 7"	21' 6"	
			24	36' 11"	31' 0"	27' 1"	26' 1"	24' 7"	21' 6"	21' 3"	21' 3"	18' 9"	
800S125-68		14	12	52' 10"	41' 11"	36' 8"	41' 11"	33' 3"	29' 1"	34' 9"	29' 1"	25' 5"	
			16	48' 0"	38' 1"	33' 3"	36' 10"	30' 3"	26' 5"	30' 1"	26' 5"	23' 1"	
			24	41' 11"	33' 3"	29' 1"	30' 1"	26' 5"	23' 1"	24' 6"	23' 1"	20' 2"	

NON-STRUCTURAL WALL HEIGHTS NOTES

- Listed lateral pressures have not been modified for strength or deflection checks.
- Studs are assumed to be adequately braced to develop full allowable moment, Ma.
- End reactions must be checked for web crippling.
- Fy = 33 ksi for 18-mil through 43-mil studs; Fy = 50 ksi for 54-mil and thicker sections.
- Allowable Heights based on steel properties only (non-composite design).
- End shear considered to be at an unpunched section.